

MANUALS • ENCLOSURE

REPLACING THE LOCKING HANDLE



26. 08. 2021

www.ALBIXON.com



Figure 1

Remove the caps on the old locking handle using a snap off knife or flat-head screwdriver.



Figure 2

Top plastic cap.



Figure 3

Bottom plastic cap.

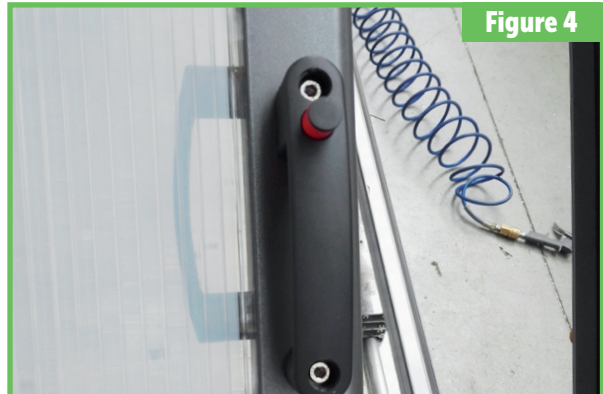

Figure 4

Remove the caps to gain access to the screws.



Figure 5

Remove the screws (5mm Allen head).

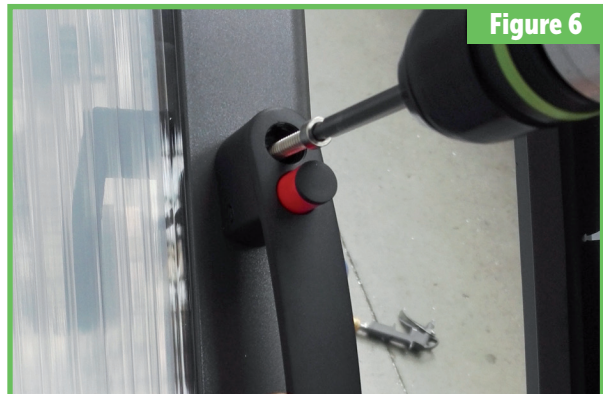

Figure 6

Remove the non-functioning handle from the profile.



Figure 7

Insert the new handle into the profile.



Figure 8

Screw in the new handle using the original screws (C6.3x38mm).

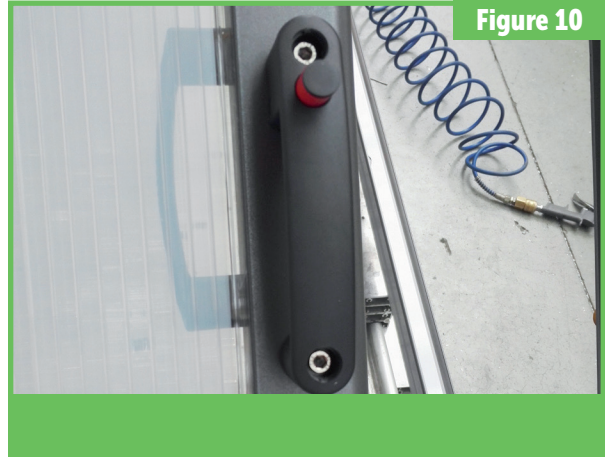

Thank you for using ALBIXON products



www.ALBIXON.com

Note that the photos used in the manual are illustrative only.
Printing and typesetting errors reserved.